

QUICK SET-UP

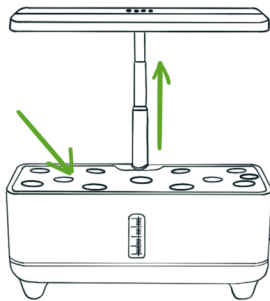

ADD PLANT TRAY
AND RAISE
THE PLANT LIGHT

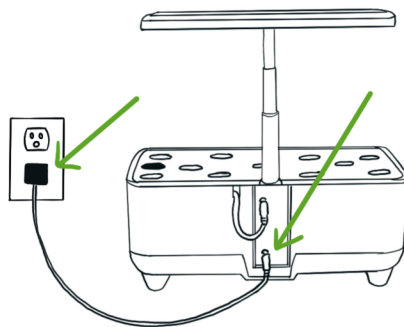

PLUG IN
POWER CORD

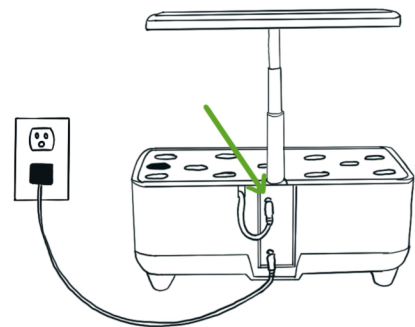



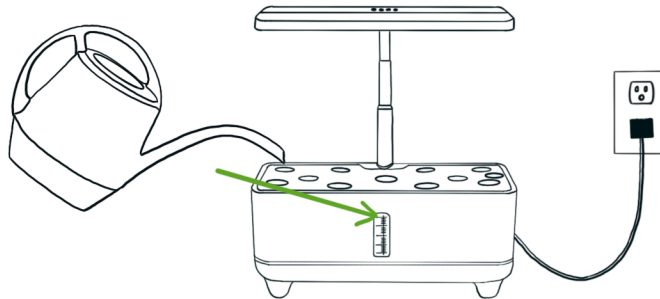

TAKE WATER PUMP CORD
(INSIDE BASIN)
AND PLUG INTO
BACK OF GARDEN

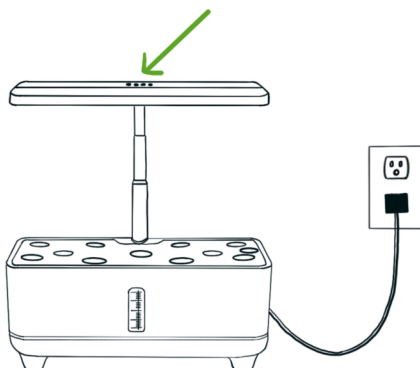

ADD 5L OF WATER TO BASIN
*MAKE SURE TO ADD WATER
BEFORE TURNING ON GARDEN



TURN ON POWER,
PUMP, AND LIGHT

-  PRESS POWER BUTTON TO TURN ON MACHINE
(YOU WILL NOT HAVE TO TOUCH THIS BUTTON AGAIN)
-  PRESS WATER PUMP BUTTON TO TURN ON PUMP
(THIS WILL RUN ON A ROTATION OF 30 MINUTES
ON/30 MINUTES OFF)
-  PRESS VEGETABLE BUTTON TO TURN ON PLANT LIGHT
(THIS FULL-SPECTRUM LIGHT WILL RUN ON A ROTATION
OF 16 HOURS ON/8 HOURS OFF)
-  PRESS FRUIT AND FLOWER BUTTON TO TURN ON PLANT LIGHT
**WE WILL NOT BE USING THIS BUTTON SINCE WE WILL BE
GROWING VEGGIES AND HERBS**